

THE INFORMATION CONTAINED IN THIS DRAWING IS THE SOLE PROPERTY OF L-COM, INC. ANY REPRODUCTION IN PART OR WHOLE WITHOUT THE WRITTEN PERMISSION OF L-COM, INC. IS PROHIBITED.

REVISIONS			
REV	DESCRIPTION	DATE	APPROVED
D	ECN999999: REMOVED PACKAGE IN POLYBAG NOTE	11/10/08	D.GRIFFIN
E	ECN 7890: UPDATED FORMAT, PACKAGING, ROHS	4/2/15	D. DESJARDIN

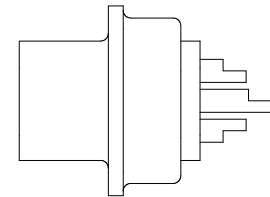
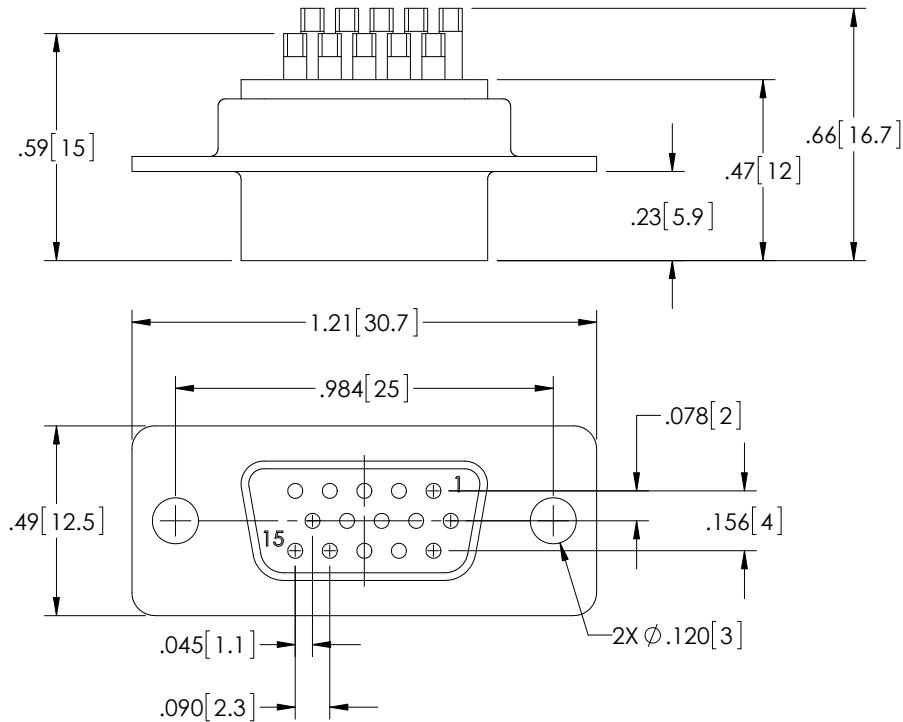

NOTES:

MATERIAL:

CONNECTOR SHELL: STEEL
 CONTACTS: BRASS
 CONNECTOR INSULATOR: THERMOPLASTIC, UL94V-0 RATED

FINISH:

CONTACTS: GOLD FLASH IN CONTACT AREA OVER NICKEL
 FRONT SHELL: NICKEL PLATED OVER COPPER
 REAR SHELL: TIN PLATED OVER COPPER
 SOLDER CUPS: TIN PLATED OVER NICKEL

ELECTRICAL:

CURRENT RATING: 1 AMP MAX
 DIELECTRIC WITHSTANDING: 500 Vac FOR 1 MINUTE
 INSULATION RESISTANCE: 1000 MΩ MIN @500 VDC
 CONTACT RESISTANCE: 30 mΩ MAX

MISCELLANEOUS:

OPERATING TEMPERATURE RANGE: -55°C TO +105°C
 PACKAGE IN ACCORDANCE WITH L-COM SPECIFICATION PS-0031.

PART NUMBER	PACKAGING
SDH15S	1/BAG
SDH15S-TRAY	50/TRAY

REGULATORY COMPLIANCE:
 CE2011/65/EU (RoHS DIRECTIVE)

UNLESS OTHERWISE SPECIFIED, DIMENSIONS ARE IN INCHES [mm] OVERALL CABLE LENGTH TOLERANCE: ≤12 [305] = +1 [25] / -0 >12 [305] ≤60 [1524] = +2 [51] / -0 >60 [1524] ≤120 [3048] = +4 [102] / -0 >120 [3048] ≤300 [7620] = +6 [152] / -0 >300 [7620] = +5% / -0% ALL OTHER DIMENSIONAL TOLERANCES: .X = ± .2 [5.08] .XX = ± .02 [51] .XXX = ± .005 [1.27]	APPROVALS	DATE
	DRAWN BY B.MAZEJKA	11/10/2003
	CHECKED BY C.McCORMICK	12/08/2003
	APPROVED BY D.PARHAM	12/08/2003
PROJECTION	CONFIGURATION DETAILS OF UNDIMENSIONED FEATURES MAY VARY	COLOR VARIATIONS MAY OCCUR
	REF	SCALE: NONE

		45 BEECHWOOD DRIVE NORTH ANDOVER, MA 01845	
CATEGORY			
D-SUBMINIATURE			
PRODUCT DESCRIPTION			
CONNECTOR, HD15F SOLDER			
SIZE	FSCM NO.	DWG. NO.	REV.
A	43321	SDH15S	E
CAD FILE: SDH15S.SLDDRW		SHEET 1 OF 1	