

THE INFORMATION CONTAINED IN THIS DRAWING IS THE SOLE PROPERTY OF L-COM, INC. ANY REPRODUCTION IN PART OR WHOLE WITHOUT THE WRITTEN PERMISSION OF L-COM, INC. IS PROHIBITED.

REVISIONS			
REV	DESCRIPTION	DATE	APPROVED
A	INITIAL RELEASE	09/10/2020	GUTTADAURO

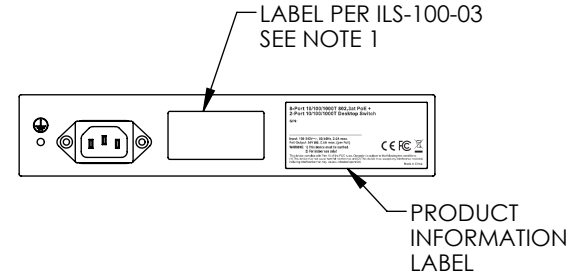
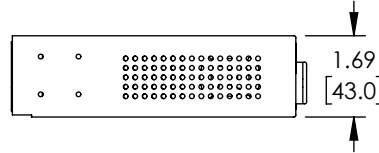
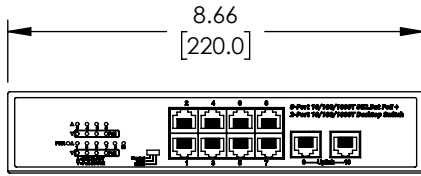

NOTES:

1. LABEL PER ILS-100-03. FOR INTERNAL REFERENCE ONLY. LABEL LOCATION FOR REFERENCE ONLY.

INTERFACE:

- 10X 10/100/1000BASE TX TRIPLE SPEED PORT, RJ45 FEMALE
- 8X 802.3AT POE+ PORTS, RJ45 FEMALE
- TOTAL PORTS: 10

POWER:

- POWER REQUIREMENTS: AC 100~240V, 50/60Hz, 2.5A MAX.
- POWER CONSUMPTION: MAX 120W / 409.4 BTU
- POE STANDARD: IEEE 802.3AT, POE+ (BACKWARDS COMPATIBLE WITH IEEE 802.3AF)
- POE TYPE: END-SPAN
- POWER PIN ASSIGNMENT: 1/2 (+), 3/6 (-)
- MAX POE POWER OUTPUT PER PORT: 32W
- TOTAL POE POWER BUDGET: 120W

ENVIRONMENTAL:

- OPERATING TEMPERATURE: 0°C - 50°C
- RELATIVE HUMIDITY: 5% - 95% (NON-CONDENSING)
- STORAGE TEMPERATURE: -10°C - 70°C

INSTALLATION OPTIONS:

- 1U RACK
- WALL MOUNT
- DESKTOP

DIP SWITCH (PLEASE REBOOT SWITCH AFTER ADJUSTING DIP SWITCH)

- STANDARD: ALL PORTS OPERATE AT 10/100/1000MBPS AUTO-NEGOTIATION
- VLAN: PORTS 1 THRU 8 ISOLATE & ONLY COMMUNICATE WITH PORTS 9 & 10
- EXTEND: PORTS 1 THRU 8 ISOLATE & ONLY COMMUNICATE WITH PORTS 9 & 10 WITH 30W POE TRANSMIT DISTANCE OF 250M AT REDUCED SPEED OF 10MBPS

PACKAGE CONTENTS:

- GIGABIT SWITCH
- POWER CORD
- RUBBER FEET
- RACK-MOUNTING BRACKETS
- SCREWS PACKAGE

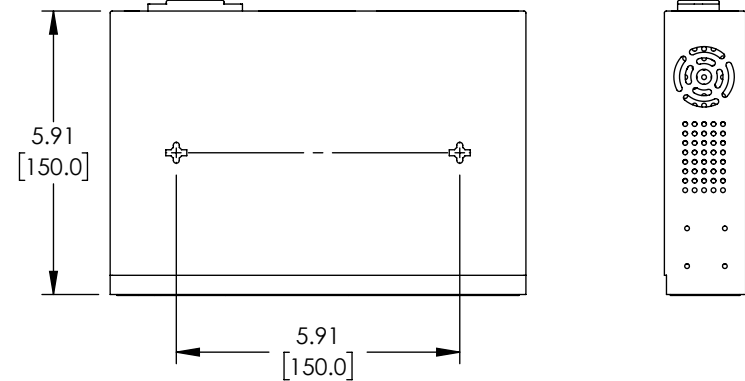

<p>UNLESS OTHERWISE SPECIFIED, DIMENSIONS ARE IN INCHES [mm]</p> <p>OVERALL CABLE LENGTH TOLERANCE: ≤12 [305] = +1 [25] / -0 >12 [305] ≤60 [1524] = +2 [51] / -0 >60 [1524] ≤120 [3048] = +4 [102] / -0 >120 [3048] ≤300 [7620] = +6 [152] / -0 >300 [7620] = +5% / -0</p> <p>ALL OTHER DIMENSIONAL TOLERANCES: .X = ± .2 [5] FRACTIONS ± 1/32 .XX = ± .02 [5] ANGLES ± 1° .XXX = ± .005 [13]</p> <p>THIRD-ANGLE PROJECTION</p>	<p>APPROVALS</p> <p>DATE</p>	<p>50 High Street, West Mill, North Andover, MA 01845 USA. Phone: 1.800.341.5266 1.978.682.6936</p>	
	<p>DRAWN BY DZINN</p> <p>CHECKED BY DFRISIELLO</p> <p>APPROVED BY GUTTADAURO</p>		<p>09/10/2020</p> <p>09/10/2020</p> <p>09/10/2020</p>
	<p>CONFIGURATION DETAILS OF UNDIMENSIONED FEATURES MAY VARY</p> <p>COLOR VARIATIONS MAY OCCUR</p>		<p>CATEGORY</p> <p>NETWORK EQUIPMENT</p>
	<p>PRODUCT DESCRIPTION</p> <p>10 Port Desktop Gigabit Ethernet Switch w/ PoE+</p>		<p>SIZE A</p> <p>CAGE CODE 43321</p> <p>ITEM NO. DT10-2G-8GP+</p> <p>SCALE: NONE</p> <p>CAD FILE: DT10-2G-8GP+-SLDDRW</p>
<p>REV. A</p>		<p>SHEET 1 OF 1</p>	