

THE INFORMATION CONTAINED IN THIS DRAWING IS THE SOLE PROPERTY OF L-COM, INC. ANY REPRODUCTION IN PART OR WHOLE WITHOUT THE WRITTEN PERMISSION OF L-COM, INC. IS PROHIBITED.

REVISIONS			
REV	DESCRIPTION	DATE	APPROVED
A	INITIAL RELEASE	05/05/17	J.LABOY

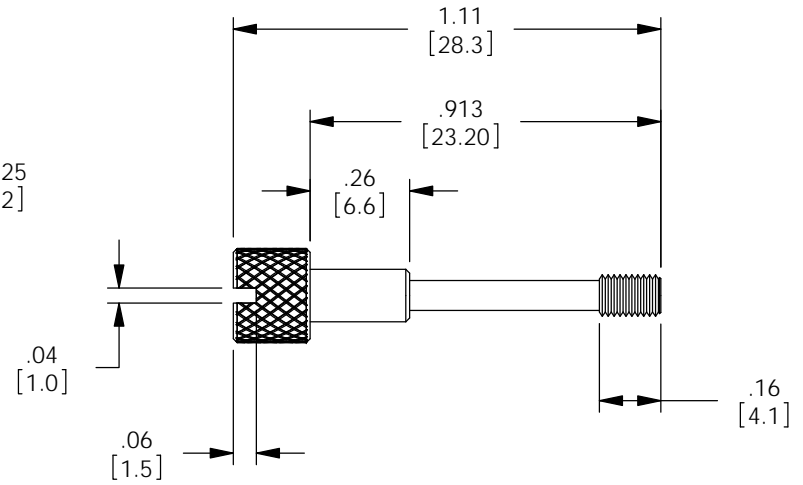
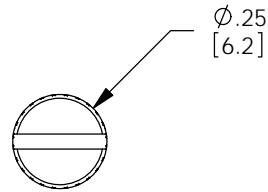
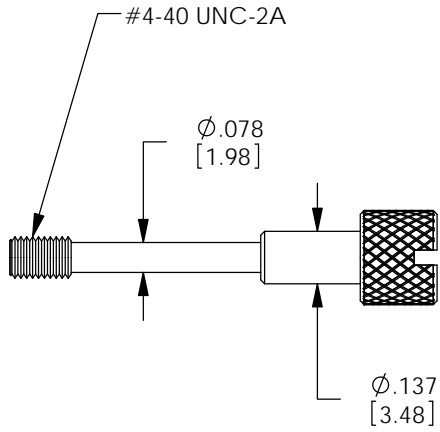

NOTES:

MATERIAL: STEEL
FINISH: NICKEL PLATE
KNURL: MEDIUM DIAMOND

MISCELLANEOUS:
COMPONENT SHALL BE PACKAGED 100 PIECES PER BAG IN ACCORDANCE WITH L-COM SPEC. PS-0031.

REGULATORY COMPLIANCE:
CE 2011/65/EU(RoHS DIRECTIVE)

UNLESS OTHERWISE SPECIFIED, DIMENSIONS ARE IN INCHES [mm] DIMENSIONAL TOLERANCES: .X = ±.1 [2.54] .XX = ±.01 [.25] .XXX = ±.005 [.13] ANGULAR TOLERANCES: ALL = ± 1°	APPROVALS	DATE			50 HIGH STREET NORTH ANDOVER, MA 01845	
	DRAWN BY S.LI	05/04/2017			CATEGORY	
	CHECKED BY B.ZHANG	05/04/2017	PRODUCT DESCRIPTION		THUMBSCREW FOR DG90XXMF1 & 2	
	APPROVED BY S.PAN	05/04/2017	SIZE A	FSCM NO. 43321	DWG. NO. DSK00001	REV. A
PROJECTION 	COLOR VARIATIONS MAY OCCUR		SCALE: NONE	CAD FILE: DSK00001.SLDDRW	SHEET 1 OF 1	