

6

5

4

3

2

1

## REVISION

ZONE	REV	DESCRIPTION	DATE	CHANGED BY	APPROVED
	A	INITIAL RELEASE	02/08/2024	AKRESOWSKI	GUTTADAURO

F

E

D

C

B

A

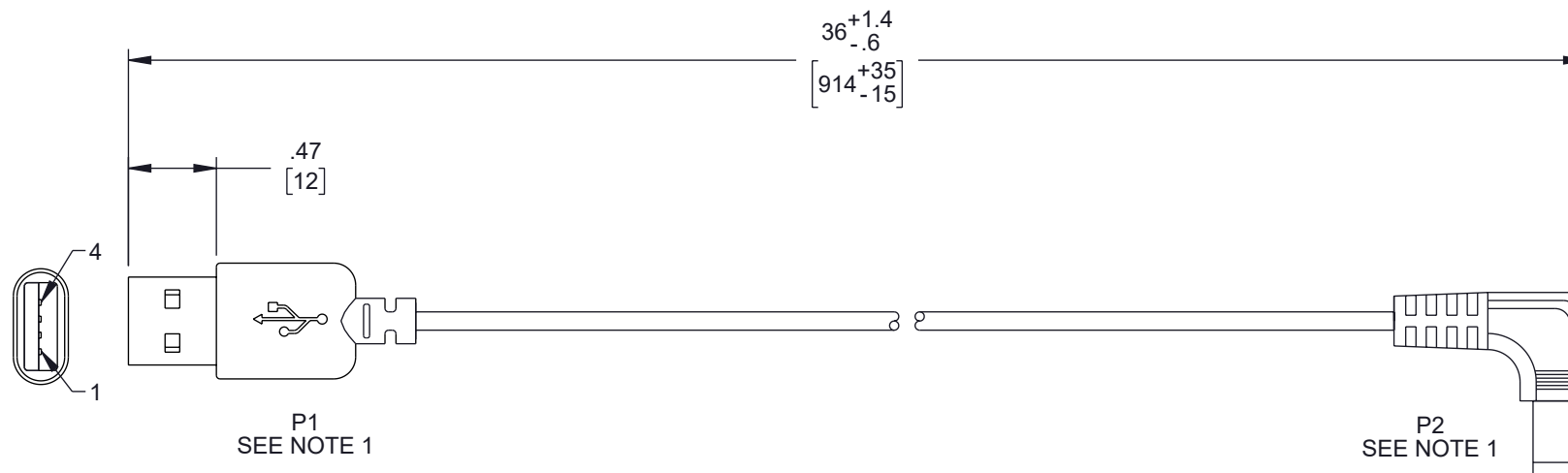

## NOTES:

- MATERIAL:**  
CABLE: 24 AWG, 2 CONDUCTORS,  
PVC JACKET OD: .138 ±.006 [3.5 ±0.15]  
MARKING: AWM 2464 80°C 300V 24AWG\*2C VW-1  
P1 PLUG: USB-A MALE, NICKEL PLATED SHELL,  
INSULATOR COLOR: WHITE  
MOLDED PVC BOOT.  
P2 PLUG: DC Ø5.5 X 2.1 mm MALE, RIGHT ANGLE,  
NICKEL PLATED SHELL,  
INSULATOR COLOR: BLACK  
MOLDED PVC BOOT.
- ELECTRICAL TEST:**  
100% OPEN SHORT AND MISS WIRE TEST.  
CONDUCTIVE RESISTANCE: 0.2 Ω MAX.  
INSULATION RESISTANCE: 10 MΩ MIN AT 300V DC.

**REGULATORY COMPLIANCE:**  
EU RoHS DIRECTIVE (MOST RECENT RELEASED VERSION).

THE INFORMATION CONTAINED IN THIS DRAWING IS THE SOLE PROPERTY OF INFINITE ELECTRONICS, INC. ANY REPRODUCTION IN PART OR WHOLE WITHOUT THE WRITTEN PERMISSION OF INFINITE ELECTRONICS, INC. IS PROHIBITED. THESE COMMODITIES, TECHNOLOGY OR SOFTWARE WERE EXPORTED FROM THE UNITED STATES IN ACCORDANCE WITH THE EXPORT ADMINISTRATION REGULATIONS. DIVERSION CONTRARY TO U.S. LAW PROHIBITED.

LC LG Rev-D5 Asize

6

5

4

3

2

1

## WIRING MAP

P1	P2
1 ----- RED -----	(+)
4 ----- BLK -----	(-)

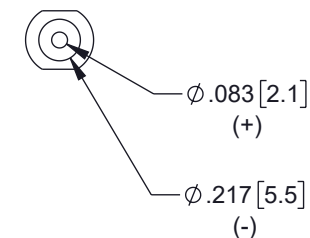

UNLESS OTHERWISE SPECIFIED  
LEADING DIMENSIONS ARE INCHES  
DIMENSIONS IN [ ] ARE MILLIMETERS

TOLERANCES:	
X = ±.2 [5]	FRACTIONS ± 1/32
.XX = ±.02 [0.5]	ANGLES ± 1°
.XXX = ±.005 [0.13]	

CABLE LENGTH TOLERANCES:	
≤12 [305]	= +1 [25] / -0
>12 [305] ≤ 60 [1524]	= +2 [51] / -0
>60 [1524] ≤ 120 [3048]	= +4 [102] / -0
>120 [3048] ≤ 300 [7620]	= +6 [152] / -0
>300 [7620]	= +5% / -0

ALL DIMENSIONS ARE FOR REFERENCE ONLY  
AND SUBJECT TO CHANGE WITHOUT NOTICE.  
UN-DIMENSIONED/NON-CRITICAL FEATURES  
MAY VARY IN SIZE AND LOCATION  
COLORS MAY VARY

**L-com®**  
an INFINIT® brand

Website: [www.L-com.com](http://www.L-com.com)  
Phone: 1.800.341.5266 | 1.978.682.6936



INTERPRET ALL DIMENSIONS AND  
TOLERANCES PER ASME Y14.5

SCALE	SHEET
NONE	1 OF 1

## DESCRIPTION

DC POWER CABLE, USB TO RIGHT ANGLE  
5.5mm/2.1mm MALE, 3 FT

SIZE	CAGE CODE	DRAWN BY	ITEM NO.	REV
A	43321	AKRESOWSKI	DC5521MRU	A