



## *TDT tool easily inserts and extracts crimp and poke type contacts*

### FOR INSERTING CONTACTS

#### STEP 1



Insert a crimped contact pin into one of the holes of a D-Sub connector.

#### STEP 2

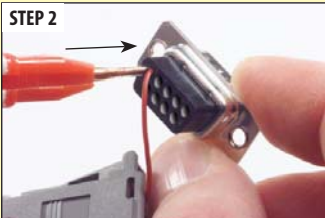

Using the red colored end of the TDT tool, push the contact pin until it stops.

#### STEP 3

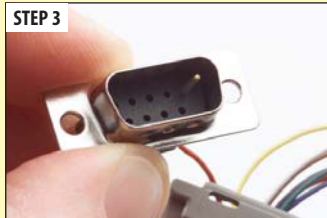

The contact pin is now seated securely in the connector.

### FOR EXTRACTING CONTACTS

#### STEP 1

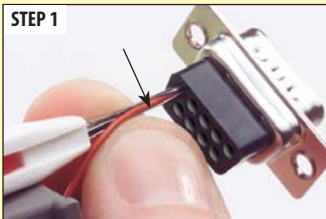

Bend and insert the wire into the track of the white end of the TDT tool.

#### STEP 2

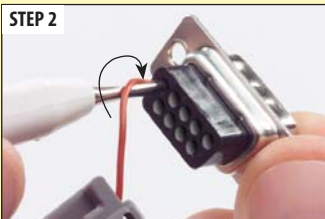

While pushing the TDT tool forward, make a slight twisting motion to grab the contact pin.

#### STEP 3

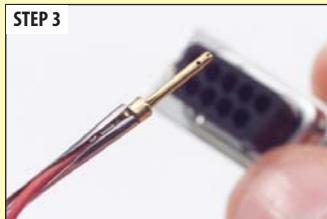

Pull the contact pin out from the connector.