



TIP: *How to panel mount adaptors*

1. Remove standard hardware provided with adaptor. Mount adaptor from rear of panel.
2. Secure with jackscrew SDG450XS (purchased separately) from front of panel.
3. Thread hex nut SDHS (purchased separately) onto exposed threads of SDG450XS.

*Note: Maximum recommended panel thickness is 0.062". Dimensions in excess of 0.062" can limit proper cable mating due to hex nut protrusion. Panels exceeding 0.062" can be milled down to the recommended thickness in the area around the adaptor.



Video clip at
www.L-com.com

STEP 1

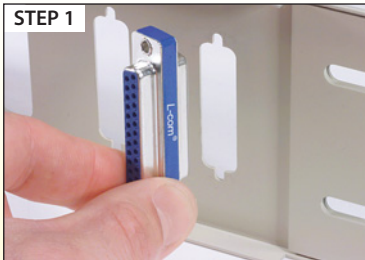

STEP 2

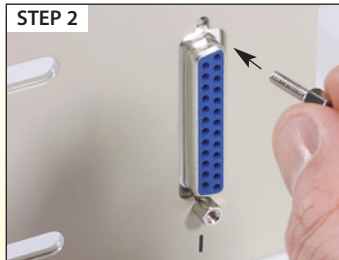

STEP 3

