

| Item #                    | Description   | Connector Orientation | 1-9   | 10-24 | 25-99 | 100-249 |
|---------------------------|---|-----------------------|-------|-------|-------|---------|
| <a href="#">CIB24BA</a>   | IEEE-488 Bulkhead Adapter, Male / Female              | Normal                | 32.00 | 29.44 | 26.88 | 24.32   |
| <a href="#">CIB24BF</a>   | IEEE-488 Bulkhead Adapter, Female / Female            | Normal                | 34.00 | 31.28 | 28.56 | 25.84   |
| <a href="#">CIB24BF-I</a> | IEEE-488 Bulkhead Adapter, Insulated, Female / Female | Normal                | 35.00 | 32.20 | 29.40 | 26.60   |

### Recommended Panel Openings for IEEE-488 GPIB Bulkhead Adapters

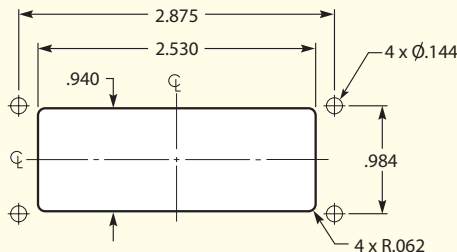

### IEEE-488 GPIB Reverse Entry Adapters - The Ultimate Solution for Many Difficult Situations

A new twist has been added to IEEE-488 networking by the introduction of reverse entry adapters. Very similar to the model CIB24BF except that the cables exit in opposite directions. This feature is sometimes desirable and necessary to avoid nearby obstructions. We also offer this reverse entry adapter with an insulated mounting bracket made of fiberglass.

|                            |   |         |       |       |       |       |
|----------------------------|---|---------|-------|-------|-------|-------|
| <a href="#">CIB24BFR</a>   | Reverse Entry IEEE-488 Bulkhead Adapter, Female / Female            | Reverse | 34.00 | 31.28 | 28.56 | 25.84 |
| <a href="#">CIB24BFR-I</a> | Reverse Entry IEEE-488 Bulkhead Adapter, Insulated, Female / Female | Reverse | 35.00 | 32.20 | 29.40 | 26.60 |

### IEEE-488 GPIB Reverse GPIB Adapter - For Easy Extension of Two Standard IEEE-488 Cables

Normally when an attempt is made to mate and extend two standard IEEE-488 cables, the result is that the cables tend to go in the same direction as shown in Entry A in the Tip below. The XFR reverse adapter will properly orient the two cables so they are in line as shown in Entry B. The double female entry makes it easy to assemble. Made of cast aluminum for light weight and durability.

|                          |  |         |       |       |       |       |
|--------------------------|--|---------|-------|-------|-------|-------|
| <a href="#">CIB24XFR</a> | 180° Reverse IEEE-488 Adapter, Female / Female | Reverse | 26.00 | 23.92 | 21.84 | 19.76 |
|--------------------------|--|---------|-------|-------|-------|-------|

### IEEE-488 GPIB Reverse Extender - Changes Cable Direction 180° and Extends Port

This is probably the most versatile extension adapter to have in case an IEEE-488 cable exit interferes with other equipment on the same rack. Simply install the Reverse Extender between the receptacle and GPIB cable.

|                         |   |         |       |       |       |       |
|-------------------------|---|---------|-------|-------|-------|-------|
| <a href="#">CIB24XR</a> | 180° Reverse IEEE-488 Extender, Male / Female | Reverse | 26.00 | 23.92 | 21.84 | 19.76 |
|-------------------------|---|---------|-------|-------|-------|-------|

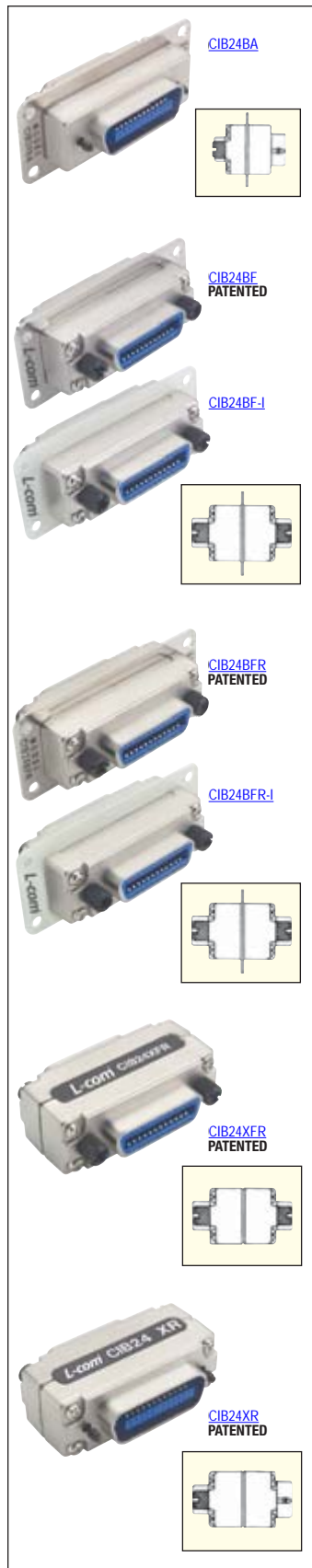

### IEEE-488 GPIB Connector Specifications

The IEEE-488 GPIB connector utilizes 24 contacts in a parallel configuration.

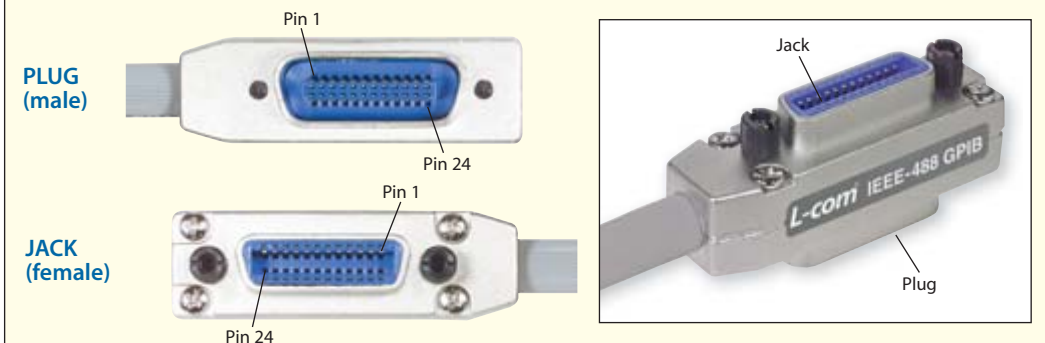

**Tip**  
**L-com reverse entry adapters solve cable extension problems in the field.**

**Before:** Typical GPIB cables with normal entry are difficult to extend.

**After:** A reverse entry adapter solves the problem.

**Same day shipping**  
 Orders placed before 4:00 EST ship the same day.