

THE INFORMATION CONTAINED IN THIS DRAWING IS THE SOLE PROPERTY OF L-COM, INC. ANY REPRODUCTION IN PART OR WHOLE WITHOUT THE WRITTEN PERMISSION OF L-COM, INC. IS PROHIBITED.

REVISONS			
REV	DESCRIPTION	DATE	APPROVED
A	RELEASED FOR PRODUCTION	03/09/09	DFP
B	ECN 4303: REVISED PACKAGING NOTE FOR PS-0031	10/6/09	D.FRISIELLO

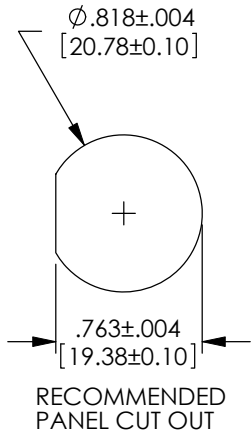
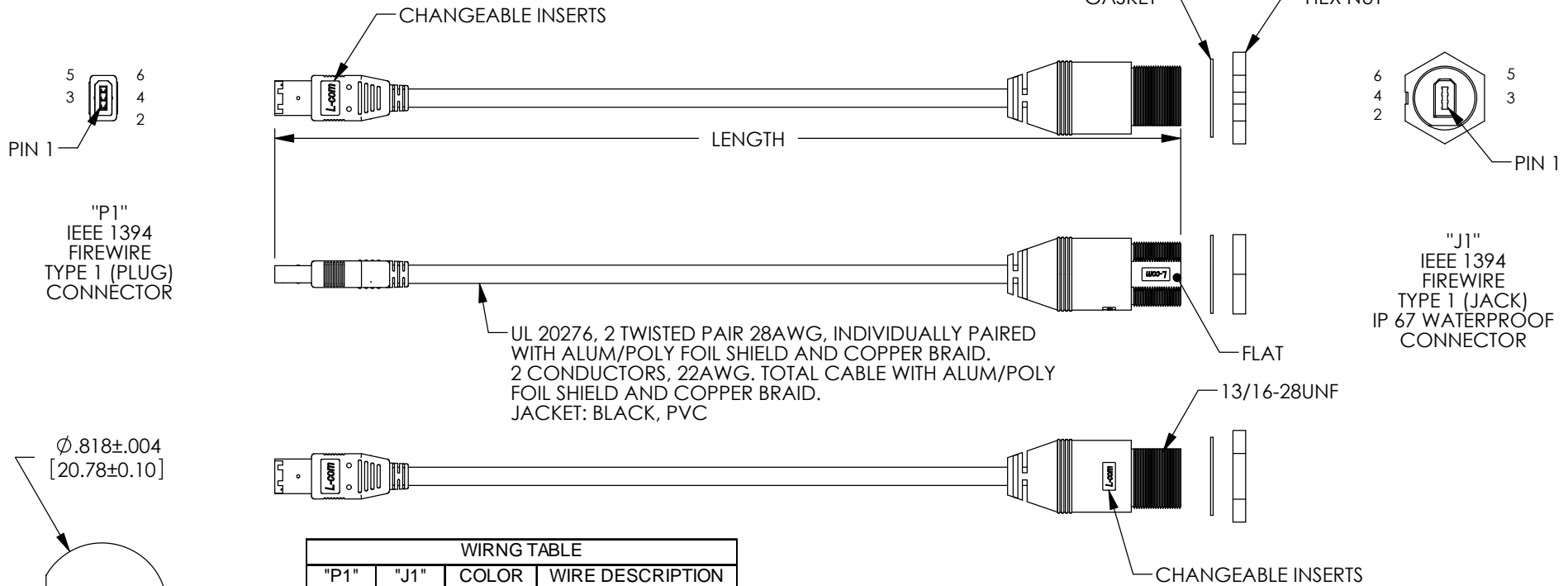

WIRNG TABLE			
"P1"	"J1"	COLOR	WIRE DESCRIPTION
1	1	WHITE	22 AWG
2	2	BLACK	22 AWG
3	3	RED	SHIELDED TWISTED PAIR
4	4	GREEN	
5	5	ORANGE	SHIELDED TWISTED PAIR
6	6	BLUE	
SHELL	SHELL		OVERALL SHIELDING
2	2		PAIR ONE SHIELDING
			PAIR TWO SHIELDING

MODEL NO.	LENGTH M [FT]
WP946PMF-05M	.5 [1.64]
WP946PMF-2M	2.0 [6.56]
WP946PMF-5M	5.0 [16.41]

NOTES:

- CABLE ASSEMBLY CONSTRUCTED TO MEET THE REQUIREMENTS OF THE IEEE - 1394 (FIREWIRE) SPECIFICATION.
- CONTACT FINISH 30μ IN GOLD (MIN.) OVER 50μ IN NICKEL (MIN.)
- TWISTED PAIRS INDIVIDUALLY SHIELDED. SHIELDS TIED TOGETHER AND TIED TO PIN 2.
- CABLE OVERALL SHIELD CONNECTED TO METAL SHELLS OF BOTH PLUGS. OVERALL SHIELD ISOLATED FROM TWISTED PAIRS' SHIELDS.
- CABLE ASSEMBLY SHALL BE TESTED FOR CONTINUITY.
- CABLE ASSEMBLY SHALL BE INDIVIDUALLY PACKAGED IN ACCORDANCE WITH L-COM SPECIFICATION PS-0031.

UNLESS OTHERWISE SPECIFIED, DIMENSIONS ARE IN INCHES [mm] OVERALL CABLE LENGTH TOLERANCE: ≤12 [305] = +1 [25] / -0 >12 [305] ≤60 [1524] = +2 [51] / -0 >60 [1524] ≤120 [3048] = +4 [102] / -0 >120 [3048] ≤300 [7620] = +6 [152] / -0 >300 [7620] = +3% / -0% ALL OTHER DIMENSIONAL TOLERANCES: .X = ± .2 .XX = ± .02 .XXX = ± .005 PROJECTION 	APPROVALS	DATE	 45 BEECHWOOD DRIVE NORTH ANDOVER, MA 01845	
	DRAWN BY D.FRISIELLO	11/12/08		
	CHECKED BY D.FORTIN	11/12/08	CATEGORY DATA CABLING	
	APPROVED BY S.SMITH	11/12/09	PRODUCT DESCRIPTION CA, WP IEEE FIREWIRE TYPE 1 M/F	
COLOR VARIATIONS MAY OCCUR	SIZE A	FSCM NO. 43321	DWG. NO. WP946PMF	REV. B
	SCALE: NONE	CAD FILE: WP946PMF.SLDDRW	SHEET 1 OF 1	