

THE INFORMATION CONTAINED IN THIS DRAWING IS THE SOLE PROPERTY OF L-COM, INC. ANY REPRODUCTION IN PART OR WHOLE WITHOUT THE WRITTEN PERMISSION OF L-COM, INC. IS PROHIBITED.

REVISIONS			
REV	DESCRIPTION	DATE	APPROVED
E	ECN 4579: CNG CONTACT FINISH BACK TO 15 U INCHES	2/26/10	D.FRISIELLO

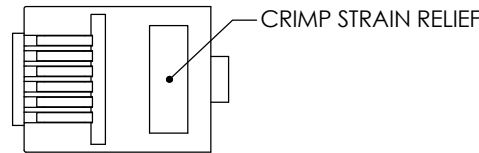
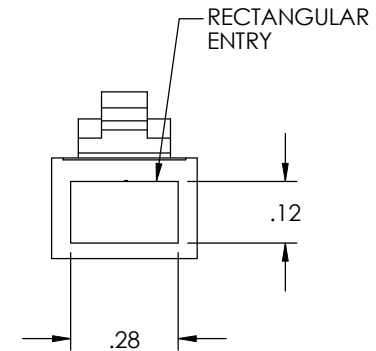
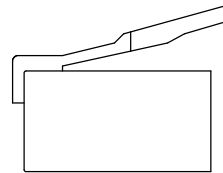
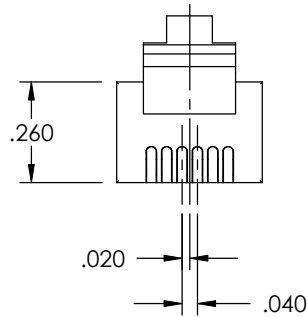
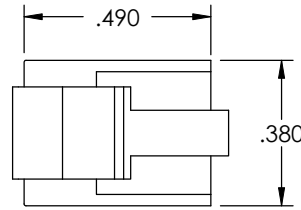

*CONTACTS SHOWN CRIMPED

NOTES:

MATERIAL:
HOUSING: POLYCARBONATE, CLEAR, UL94V-0.
CONTACTS: PHOSPHOR BRONZE.

FINISH:
CONTACTS: 15 MICROINCHES MIN. GOLD IN CONTACT AREA
OVER 100 MICROINCHES MIN. NICKEL PLATE OVERALL.

ELECTRICAL:
VOLTAGE: 125 VAC. MAX.
CURRENT: 1.5 AMPS MAX.

MECHANICAL:
CONTACT STYLE: 2 PRONG (OFFSET).
COMPATIBLE WITH SOLID AND STRANDED CONDUCTORS.
CONDUCTOR RANGE: 24 - 26 AWG.
MAX. CONDUCTOR INSULATION DIAMETER: .038 [0.96].

MISCELLANEOUS:
OPERATING TEMPERATURE RANGE: -40°C TO +85°C.
TERMINATED CONTACT HEIGHT: .237±.005 [0.96].
COMPONENT SHALL BE INDIVIDUALLY PACKAGED IN ACCORDANCE WITH L-COM SPECIFICATION PS-0031.

UNLESS OTHERWISE SPECIFIED, DIMENSIONS ARE IN INCHES [mm] OVERALL CABLE LENGTH TOLERANCE: ≤12 [305] = +1 [25] / -0 >12 [305] ≤60 [1524] = +2 [51] / -0 >60 [1524] ≤120 [3048] = +4 [102] / -0 >120 [3048] ≤300 [7620] = +6 [152] / -0 >300 [7620] = +3% / -0% ALL OTHER DIMENSIONAL TOLERANCES: .X = ±.2 .XX = ±.02 .XXX = ±.005	APPROVALS	DATE		45 BEECHWOOD DRIVE NORTH ANDOVER, MA 01845	
	DRAWN BY D PARHAM	3/27/2002			CATEGORY MODULAR
	CHECKED BY T CLARK	3/28/2002			
	APPROVED BY C MCCORMICK	3/28/2002			PRODUCT DESCRIPTION RJ12 PLUG (6X6), UNSHIELDED
PROJECTION	CONFIGURATION DETAILS OF UNDIMENSIONED FEATURES MAY VARY		SIZE A FSCM NO. 43321 DWG. NO. TD6P6C REV. E		
	COLOR VARIATIONS MAY OCCUR		SCALE: NONE CAD FILE: TD6P6C.SLDDRW SHEET 1 OF 1		

