

THE INFORMATION CONTAINED IN THIS DRAWING IS THE SOLE PROPERTY OF L-COM, INC. ANY REPRODUCTION IN PART OR WHOLE WITHOUT THE WRITTEN PERMISSION OF L-COM, INC. IS PROHIBITED.

REVISIONS			
REV	DESCRIPTION	DATE	APPROVED
A	INITIAL RELEASE	10/25/11	D.GRIFFIN

THUMBSCREW WILL FIT THE FOLLOWING:

USED ON	
CTL3VGAMM-5T	CTLB3VGAMM-15TP
CTL3VGAMM-10T	CTLB3VGAMM-20TP
CTL3VGAMM-15T	CTLB3VGAMM-25TP
CTL3VGAMM-25T	CTLB3VGAMM-50TP
CTL3VGAMM-50T	CTLB3VGAMM-75TP
CTL3VGAMF-5T	CTLKMMM-5T
CTL3VGAMF-10T	CTLKMMM-10T
CTL3VGAMF-15T	CTLKMMM-15T
CTL3VGAMF-25T	CTLKMMM-25T
CTL3VGAMF-50T	CTLKMMM-50T
CTL3VGAMM-5TP	CTLKVMF-5T
CTL3VGAMM-10TP	CTLKVMF-10T
CTL3VGAMM-15TP	CTLKVMF-15T
CTL3VGAMM-25TP	CTLKVMF-25T
CTL3VGAMM-50TP	CTLKVMF-50T
CTL3VGAMF-5TP	CTLKMMM-5TP
CTL3VGAMF-10TP	CTLKMMM-10TP
CTL3VGAMF-15TP	CTLKMMM-15TP
CTL3VGAMF-25TP	CTLKMMM-25TP
CTL3VGAMF-50TP	CTLKMMM-50TP
CTLB3VGAMM-15T	CTLKVMF-5TP
CTLB3VGAMM-20T	CTLKVMF-10TP
CTLB3VGAMM-25T	CTLKVMF-15TP
CTLB3VGAMM-50T	CTLKVMF-25TP
CTLB3VGAMM-75T	CTLKVMF-50TP
	CTL5CAR-2T

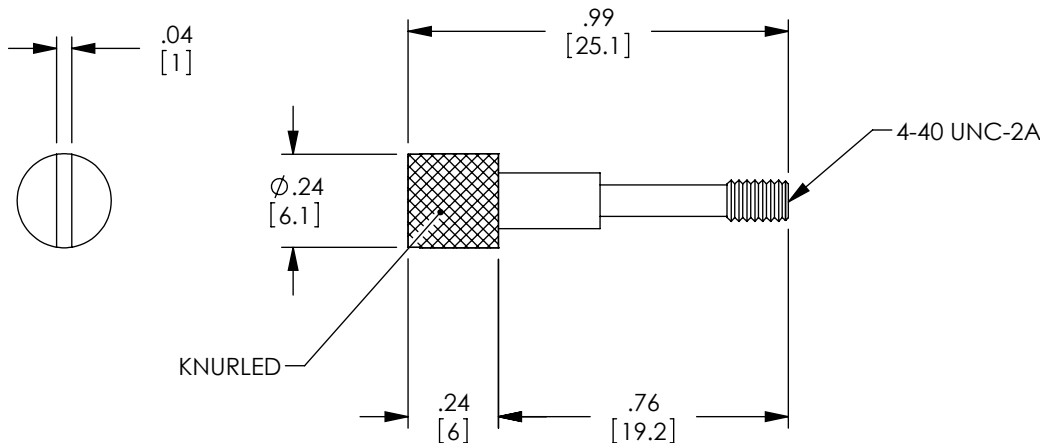

NOTES:

1. MATERIAL: STEEL, NICKEL PLATED.
2. ALL DIMENSIONS ARE FOR REFERENCE ONLY.
3. COMPONENT SHALL BE PACKAGED IN QTY OF 25.

**RoHS Compliant** ✓

UNLESS OTHERWISE SPECIFIED, DIMENSIONS ARE IN INCHES [mm] OVERALL CABLE LENGTH TOLERANCE: ≤12 [305] = +1 [25] / -0 >12 [305] ≤60 [1524] = +2 [51] / -0 >60 [1524] ≤120 [3048] = +4 [102] / -0 >120 [3048] ≤300 [7620] = +6 [152] / -0 >300 [7620] = +3% / -0% ALL OTHER DIMENSIONAL TOLERANCES: .X = ±.2 .XX = ±.02 .XXX = ±.005	APPROVALS DRAWN BY D.FRISIELLO	DATE 10/24/11		45 BEECHWOOD DRIVE NORTH ANDOVER, MA 01845
	CHECKED BY R.SCOTT APPROVED BY P.McNEIL	10/24/11 10/24/11		CATEGORY HARDWARE
PROJECTION 	CONFIGURATION DETAILS OF UNDIMENSIONED FEATURES MAY VARY	PRODUCT DESCRIPTION THUMBSCREW FOR THIN-LINE VIDEO MOLDED HOODS	SCALE: NONE CAD FILE: CTL-T-SCREW.SLDDRW	SHEET 1 OF 1
COLOR VARIATIONS MAY OCCUR	SIZE <b>A</b>	FSCM NO. <b>43321</b>	DWG. NO. <b>CTL-T-SCREW</b>	REV. <b>A</b>