

THE INFORMATION CONTAINED IN THIS DRAWING IS THE SOLE PROPERTY OF L-COM, INC. ANY REPRODUCTION IN PART OR WHOLE WITHOUT THE WRITTEN PERMISSION OF L-COM, INC. IS PROHIBITED.

REVISIONS			
REV	DESCRIPTION	DATE	APPROVED
A	INITIAL RELEASE	9/30/10	D.GRIFFIN
B	ECN 5780: REVISED GOLD PLATE TO NICKEL PLATE	10/17/11	D.FRISIELLO
C	ECN 8627: REVISE TO NEW VENDOR SPEC. ALL NOTES, FORMAT	2/2/17	D.FRISIELLO

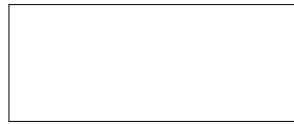

FERRULE

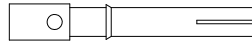

CONTACT PIN  
(SOLDER TYPE)

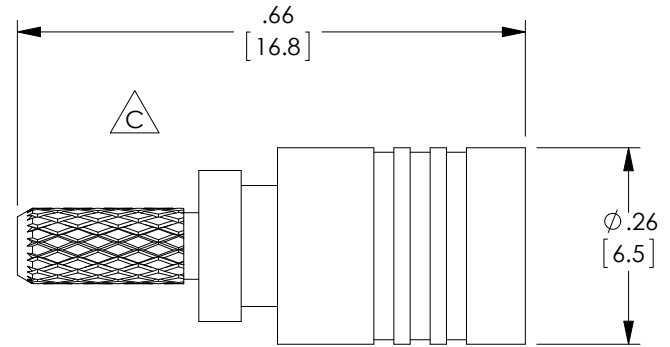

BODY



NOTES

- MATERIAL:**  
 CENTER CONTACT: BERYLLIUM COPPER;  
 FINISH: GOLD COVER NICKEL PLATED  
 BODY: BRASS; FINISH: NICKEL PLATED  
 INSULATOR: PTFE; COLOR: WHITE
- ELECTRICAL:**  
 IMPEDANCE: 50 OHMS  
 VSWR: 1.3 MAX. @DC ~ 3GHz (USEABLE TO 10 GHz)  
 INNER CONTACT RESISTANCE: 6 MILLIOHMS  
 DIELECTRIC WITHSTANDING: 750VAC rms  
 INSULATION RESISTANCE: 1000 MEGA OHMS  
 OPERATING TEMPERATURE: -40 °C ~ +85 °C  
 STORAGE TEMPERATURE: -25 °C ~ +75 °C
- MISCELLANEOUS:**  
 DURABILITY: 500 CYCLES  
 APPLICATIONS: LMR100, RG174/U, RG188A/U, RG316/U.  
 ALL DIMENSIONS ARE FOR REFERENCE ONLY.  
 COMPONENT SHALL BE INDIVIDUALLY PACKAGED IN ACCORDANCE WITH L-COM SPECIFICATION PS-0031.

**REGULATORY COMPLIANCE:**  
 CE2011/65/EU(RoHS DIRECTIVE)

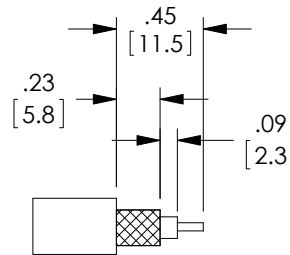

RECOMMENDED  
CABLE STRIPPING

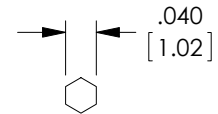

CRIMP FERRULE SIZE



UNLESS OTHERWISE SPECIFIED, DIMENSIONS ARE IN INCHES [mm] OVERALL CABLE LENGTH TOLERANCE: ≤12 [305] = +1 [25] / -0 >12 [305] ≤60 [1524] = +2 [51] / -0 >60 [1524] ≤120 [3048] = +4 [102] / -0 >120 [3048] ≤300 [7620] = +6 [152] / -0 >300 [7620] = +3% / -0%	APPROVALS	DATE		45 BEECHWOOD DRIVE NORTH ANDOVER, MA 01845
	DRAWN BY D.FRISIELLO	9/27/10		CATEGORY
ALL OTHER DIMENSIONAL TOLERANCES: .X = ±.2 .XX = ±.02 .XXX = ±.005	CHECKED BY K.BURGNER	9/27/10	PRODUCT DESCRIPTION <b>CONN, SMB PLUG CRIMP LMR100          RG188, RG316, RG174</b>	REV. <b>C</b>
PROJECTION 	APPROVED BY K.BURGNER	9/27/10		
SCALE: NONE			CAD FILE: ASMBP-1100.SLDDRW	
			SHEET 1 OF 1	